

A DIFFERENT KIND OF WORKSPACE



THIS IS NOON

NOON is a self-contained collection of serviced offices located on the second floor of 101 Princess Street. Named after the time of day when social interactions flourish, it's designed for fluidity-where deep work and collaboration happen in the same space.

Whether you need a quiet corner to focus or a vibrant setting to connect, NOON moves with you. It's the warmth of a boutique workspace with the ease of a private club-no forced structure, just effortless flow.



WHO IS NOON FOR?

NOON is for those who want more than just a desk—it's for businesses and individuals who thrive in a space that feels as good as it functions.



Entrepreneurs

who need a dynamic, flexible, professional base



Creatives and freelancers

who crave an inspiring setting.



Small teams

looking for a mix of collaboration and private workspaces.



Anyone

who values design, community, and a fresh approach to work.

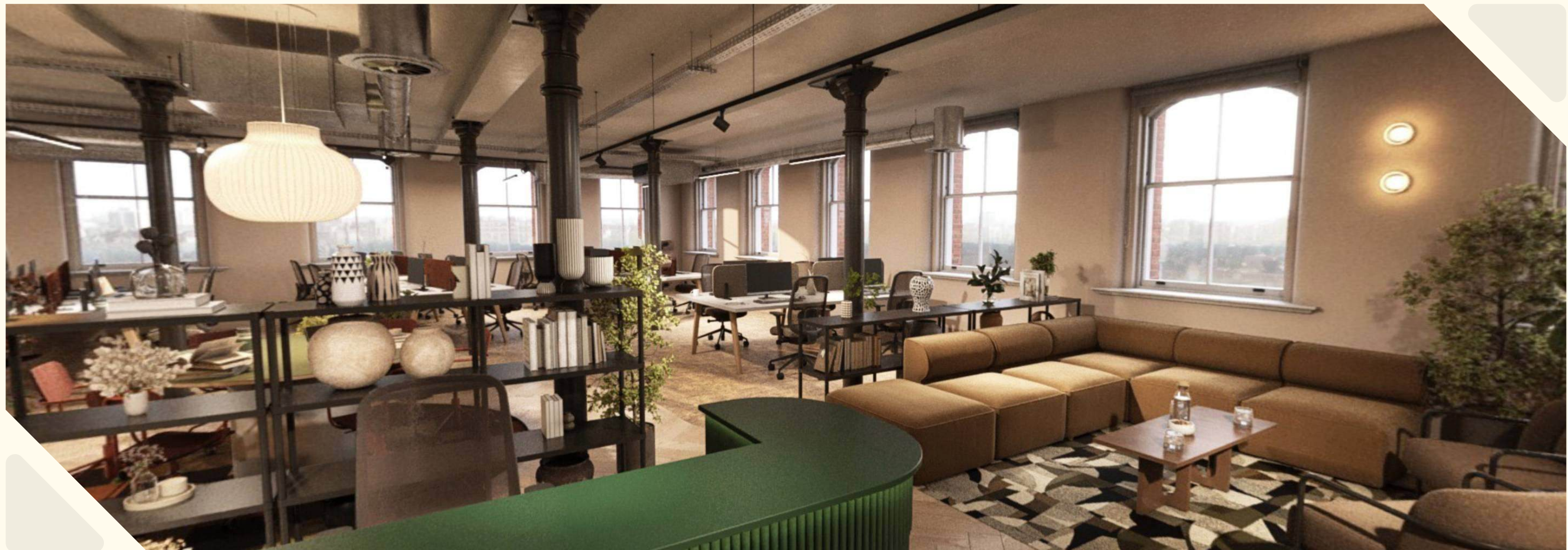

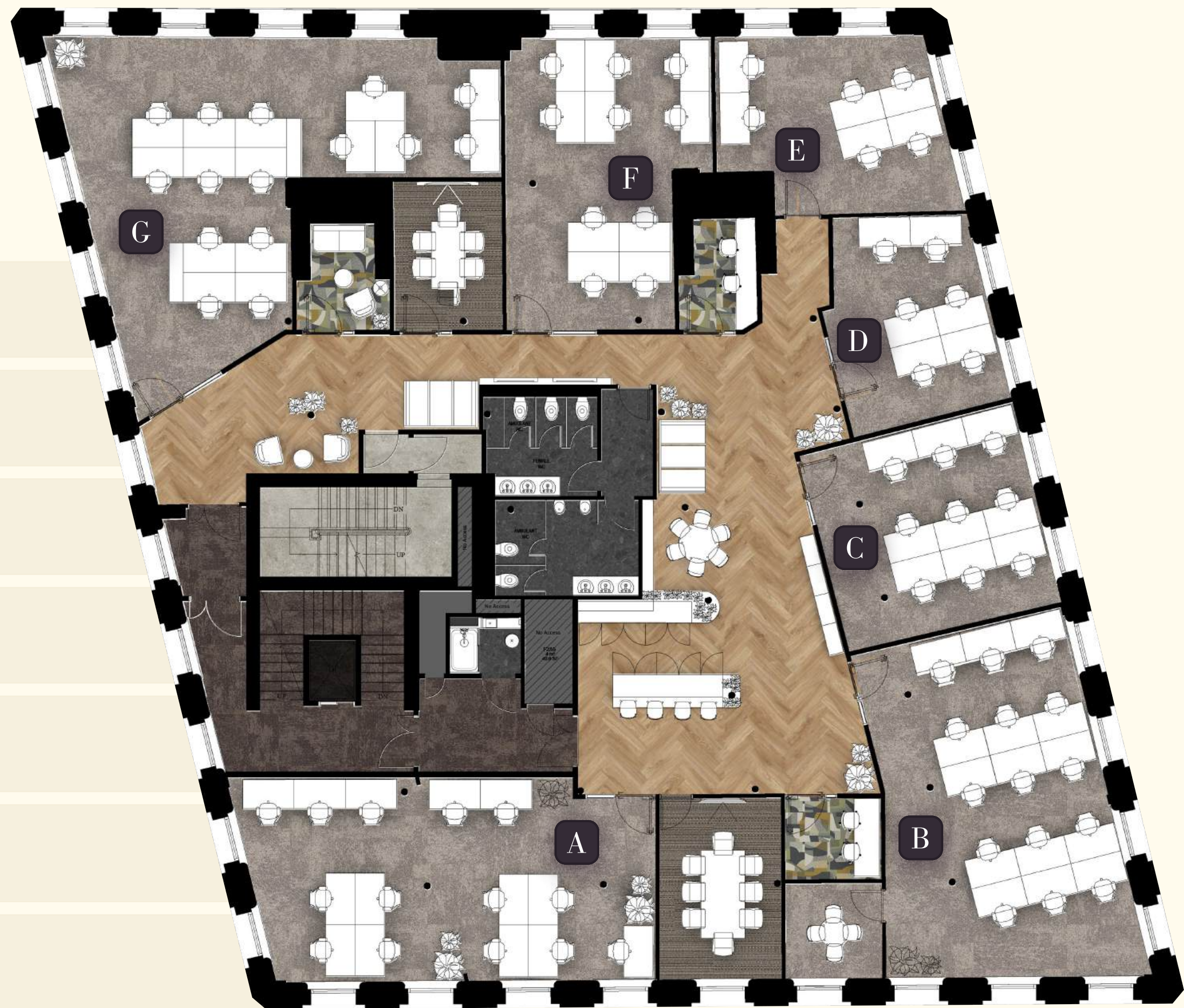

NOON SPACES

- A** 635 SQ FT | 14 Desks
- B** 721 SQ FT | 15 Desks
- C** 355 SQ FT | 9 Desks
- D** 258 SQ FT | 6 Desks
- E** 301 SQ FT | 6 Desks
- F** 430 SQ FT | 10 Desks
- G** 786 SQ FT | 15 Desks

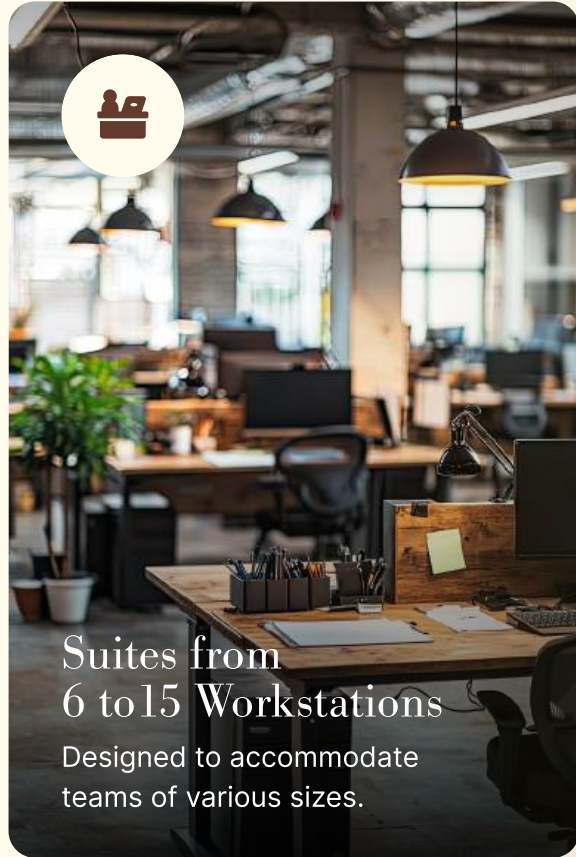

EVERYTHING YOU NEED





Suites from 6 to 15 Workstations
Designed to accommodate teams of various sizes.

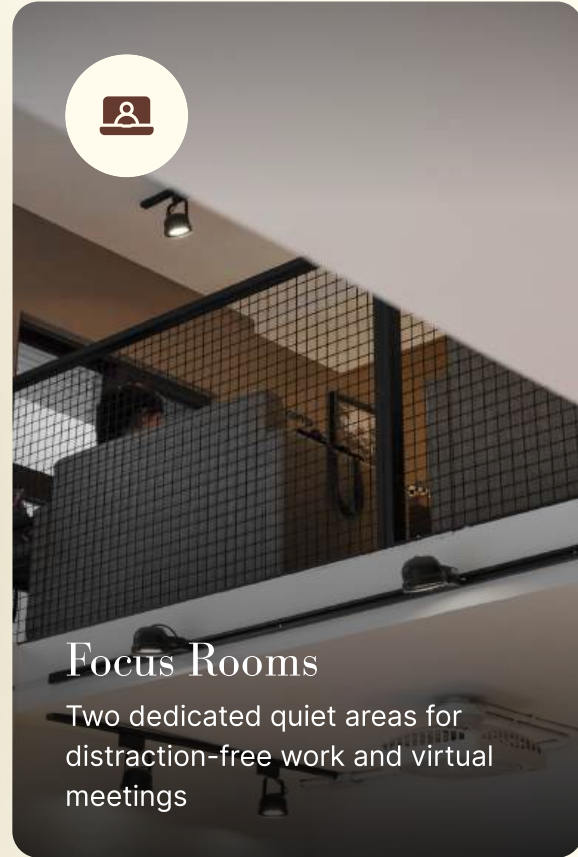
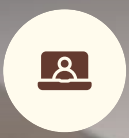

Meeting Rooms
Two formal and an informal meeting room. High-spec spaces for seamless collaboration

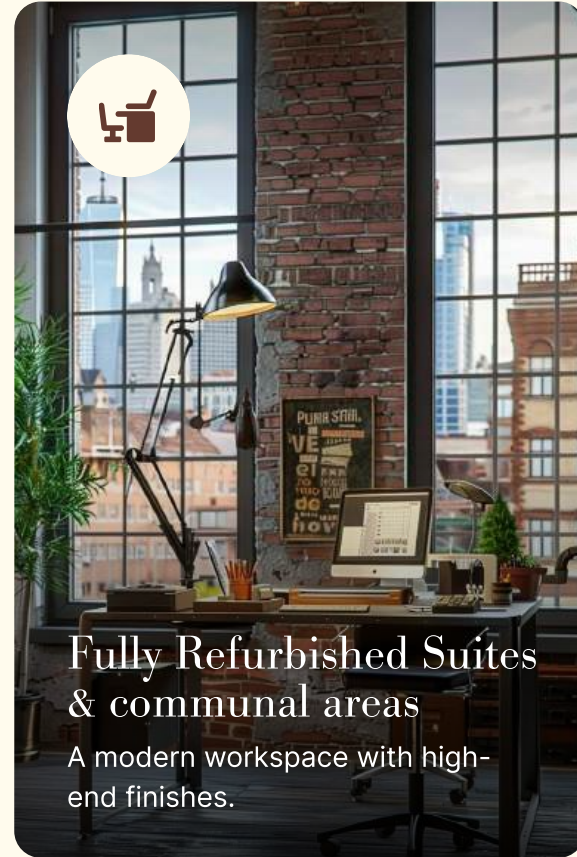

Focus Rooms
Two dedicated quiet areas for distraction-free work and virtual meetings





Fully Refurbished Suites & communal areas
A modern workspace with high-end finishes.

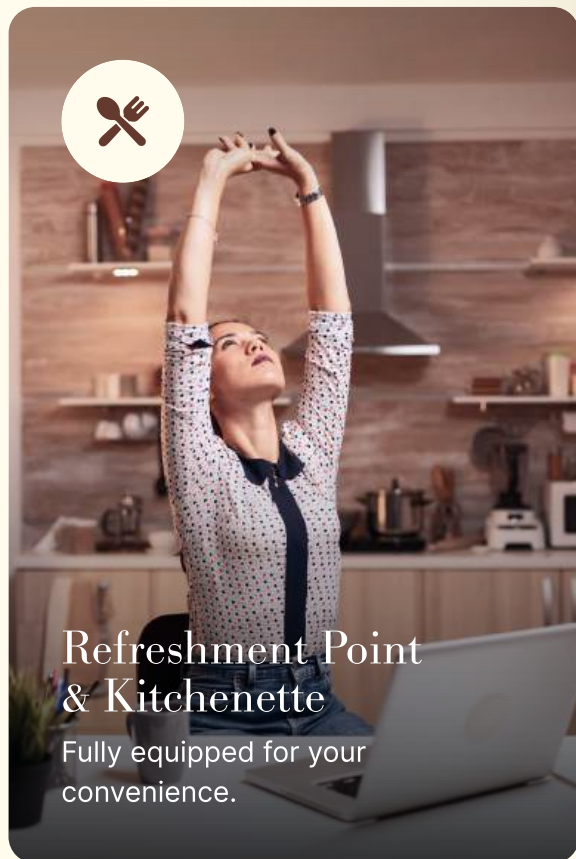

Superfast "Day One" Connectivity
Ultra-fast, secure internet for seamless business operations.

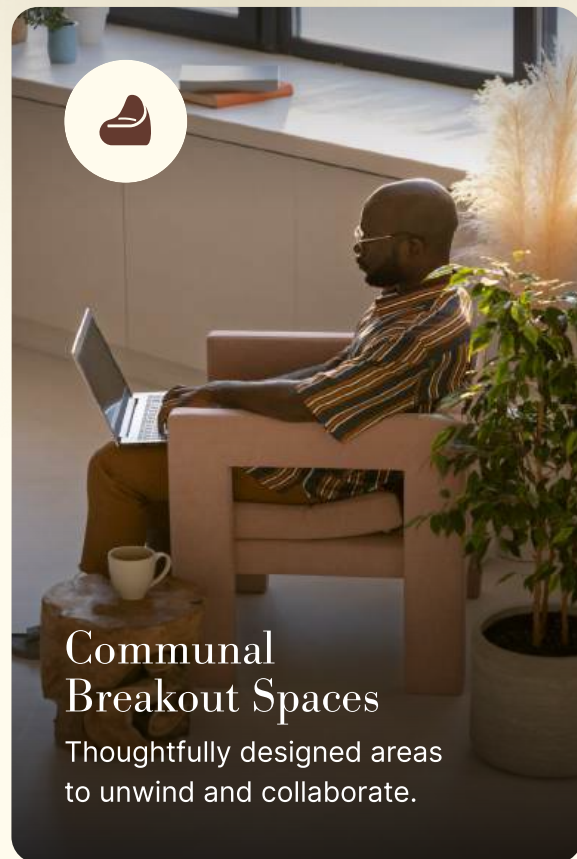

Refreshment Point & Kitchenette
Fully equipped for your convenience.





Communal Breakout Spaces
Thoughtfully designed areas to unwind and collaborate.



Shower & Amenity Space
Facilities designed for comfort and convenience.

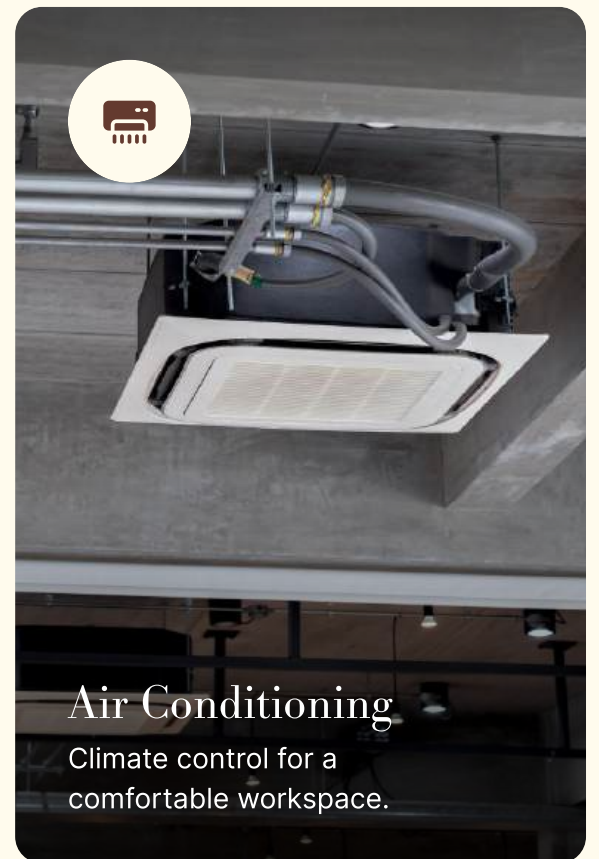

Male & Female WC's
Dedicated on-floor washrooms.



Air Conditioning
Climate control for a comfortable workspace.

STEP INSIDE NOON



READY TO EXPERIENCE NOON?

Contact us to learn more and
let us know how we can help.

Sixteen.

Rosie Veitch



rosie@sixteenrealestate.com



07746249920

Scott Shufflebottom



scott@sixteenrealestate.com



07715683369

Delivered by YAKEL



www.101princessstreet.com



[Linkedin Profile](#)

Sixteen Real Estate for themselves and for the vendors or lessors of this property, whose agents they are giving notice that:

- a) all particulars are set out as a general outline only for the guidance of intending purchasers or lessees, and do not comprise part of an offer or contract:
- b) all descriptions, dimensions, references to condition and necessary permissions for use and occupation, and other details are given in good faith and are believed to be correct but any intending purchasers or tenants should not rely on them as statements or representations of fact but must satisfy themselves by inspection or otherwise as to the correctness of each of them.
- c) no person in the employment of Sixteen Real Estate has any authority to make any representation of warranty whatsoever in relation to this property. September 2024.